

iITXL-1900A (MZBAYAI)

Thin Mini-ITX Embedded Motherboard with Intel® J1900 Processor, Dual Channel DDR3L memory, 1 x COM, 2 x SATA 3Gb/s, 6 x USB



Features

- Thin Mini-ITX form factor
- Intel® Celeron® Processor J1900
- Dual Channel DDR3L, 2 x SO-DIMMs
- 1 x GbE LAN port
- 2 x SATA 3Gb/s ports, 1 x SATA 6Gb/s (optional)
- HDMI, VGA, LVDS ports for multiple display
- 1 x PCIe x4 (2.0 x4 bus)
- 1 x RS232 COM port

Specifications

Form Factor	Thin Mini-ITX 170W x 170D (mm)
CPU	Intel® Celeron® Processor J1900 22nm, 4 cores, 4 threads, up to 2.42 GHz TDP 10W
Socket	1 x FCBGA1170
Chipset	—
Memory	2 x DDR3L SO-DIMM sockets, Max. Capacity 8GB Support Dual channel DDR3L 1333MHz memory modules
Ethernet	1 x GbE LAN port (Realtek® RTL8111G)
Video	Integrated Graphics Processor - Intel® HD Graphics: 1 x HDMI 1.4 port, supporting max. resolution of 1920x1080 @60Hz 1 x VGA port, supporting max. resolution of 2560x1600 @60Hz 1 x LVDS port, supporting max. resolution of 1920x1080 @60Hz (2 independent display outputs)
Audio	Realtek® Audio Codec
Storage	1 x SATA 6Gb/s port (switches with mSATA) 2 x SATA 3Gb/s ports eMMC (Optional)
Raid	—
Expansion Slots	1 x PCIe x4 (Gen2 x1) 1 x mSATA (SATA 6Gb/s) 1 x Half-size Mini PCIe

Internal I/O	1 x 2-pin ATX main power connector 1 x SATA power connector 1 x CPU fan header 1 x System fan header 1 x Front panel header 1 x Front audio header 1 x 3W Speaker out header 1 x DMIC header 3 x USB 2.0 headers 1 x COM Header (RS-232) 1 x FPD (For LVDS 19V) 1 x FPD_SW 1x3 (For Panel Power SW) 1 x LCD_VCC Pin header 1 x Backlight Control header 1 x LPT header 1 x Micro SD connector
Rear I/O	2 x Audio jacks (Line out, Mic in) 1 x HDMI 1 x VGA 1 x RJ45 LAN port 2 x USB 2.0 1 x USB 3.0 1 x DC Jack (+12V/+19VDC)
TPM	—
OS Compatibility	Windows 7 (x64) Windows 8 (x64) Windows 8.1 (x64)
Operating Properties	Operating temperature: 0°C to 60°C Operating humidity: 0-90% (non-condensing) Non-operating temperature: -20°C to 70°C Non-operating humidity: 0%-95% (non-condensing)

GIGAIPC reserves the right to modify or change technical data without prior notice.

Dimension

Unit: mm

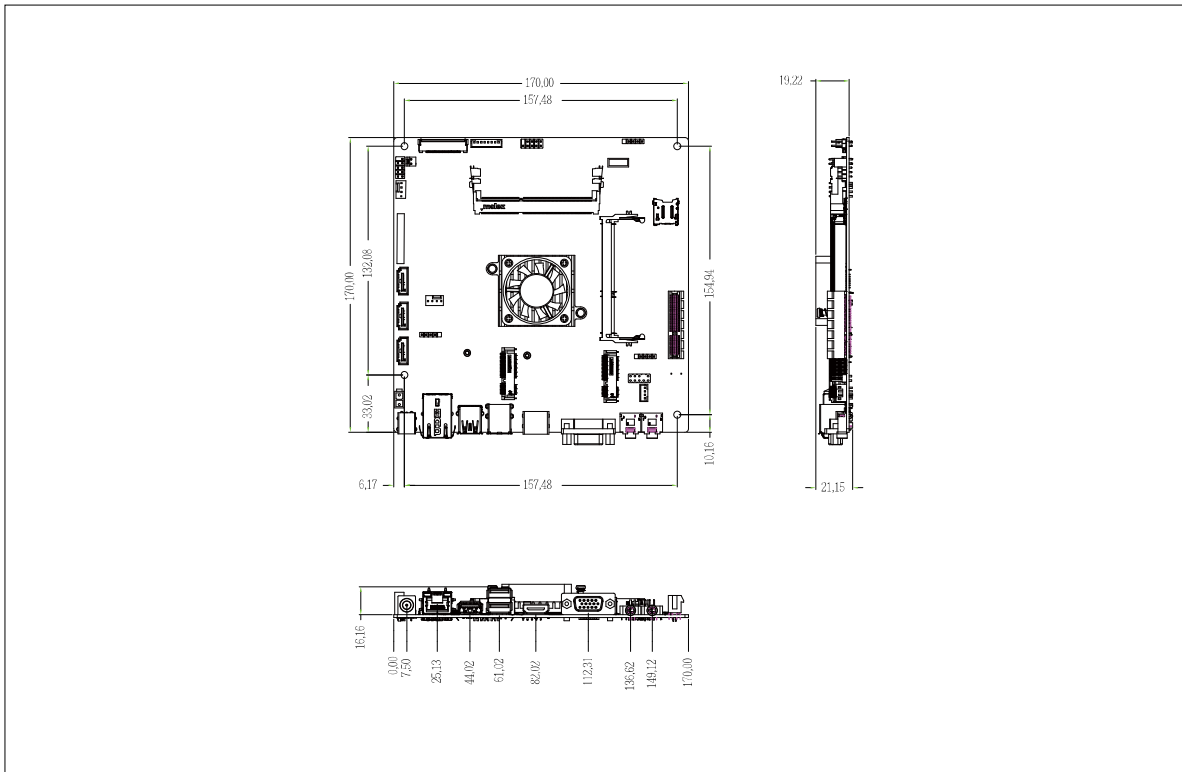

Packing Content

- Bulk Packing Capacity: 20pcs
- Carton size: 550 x 451 x 330(mm)
- Content:
 - IO Shield x 1 (P/N: 12AIO-MZBAY1-00R)
 - IO Shield STD x 1(P/N: 12AIO-MZBAY0-00R)
 - SCREW I HEAD M2x4L H=0.8 x 3 (P/N: 25KSG-130042-S0R)
 - SATA Power cable x 1 (P/N: 25CRI-710300-S8R)
 - Driver CD x 1 (P/N: 12DC1-10MZBA-00R)

Ordering Information

- Motherboard: 9MZBAYAINR-SI

GIGAIPC reserves the right to modify or change technical data without prior notice.