

# mSATA mini

## 3ME Series

**Customer:** \_\_\_\_\_

**Customer**

**Part**

**Number:** \_\_\_\_\_

**Innodisk**

**Part**

**Number:** \_\_\_\_\_

**Innodisk**

**Model Name:** \_\_\_\_\_

**Date:** \_\_\_\_\_

<b>Innodisk Approver</b>	<b>Customer Approver</b>

**innodisk**

**Total Solution For  
Industrial Flash Storage**

## Table of contents

<b>LIST OF FIGURES</b> .....	<b>6</b>
<b>1. PRODUCT OVERVIEW</b> .....	<b>7</b>
<b>1.1 INTRODUCTION OF INNODISK MSATA MINI 3ME</b> .....	<b>7</b>
<b>1.2 PRODUCT VIEW AND MODELS</b> .....	<b>7</b>
<b>1.3 SATA INTERFACE</b> .....	<b>7</b>
<b>2. PRODUCT SPECIFICATIONS</b> .....	<b>8</b>
<b>2.1 CAPACITY AND DEVICE PARAMETERS</b> .....	<b>8</b>
<b>2.2 PERFORMANCE</b> .....	<b>8</b>
<b>2.3 ELECTRICAL SPECIFICATIONS</b> .....	<b>8</b>
<b>2.3.1 Power Requirement</b> .....	<b>8</b>
<b>2.3.2 Power Consumption</b> .....	<b>8</b>
<b>2.4 ENVIRONMENTAL SPECIFICATIONS</b> .....	<b>9</b>
<b>2.4.1 Temperature Ranges</b> .....	<b>9</b>
<b>2.4.2 Humidity</b> .....	<b>9</b>
<b>2.4.3 Shock and Vibration</b> .....	<b>9</b>
<b>2.4.4 Mean Time between Failures (MTBF)</b> .....	<b>9</b>
<b>2.5 CE AND FCC COMPATIBILITY</b> .....	<b>10</b>
<b>2.6 RoHS COMPLIANCE</b> .....	<b>10</b>
<b>2.7 RELIABILITY</b> .....	<b>10</b>
<b>2.8 TRANSFER MODE</b> .....	<b>10</b>
<b>2.9 PIN ASSIGNMENT</b> .....	<b>10</b>
<b>2.10 MECHANICAL DIMENSIONS</b> .....	<b>12</b>
<b>2.11 ASSEMBLY WEIGHT</b> .....	<b>12</b>
<b>2.12 SEEK TIME</b> .....	<b>12</b>
<b>2.13 NAND FLASH MEMORY</b> .....	<b>12</b>
<b>3. THEORY OF OPERATION</b> .....	<b>13</b>
<b>3.1 OVERVIEW</b> .....	<b>13</b>
<b>3.2 SATA III CONTROLLER</b> .....	<b>13</b>
<b>3.3 ERROR DETECTION AND CORRECTION</b> .....	<b>14</b>
<b>3.4 WEAR-LEVELING</b> .....	<b>14</b>
<b>3.5 BAD BLOCKS MANAGEMENT</b> .....	<b>14</b>
<b>3.6 POWER CYCLING</b> .....	<b>14</b>
<b>3.7 GARBAGE COLLECTION</b> .....	<b>14</b>
<b>4. INSTALLATION REQUIREMENTS</b> .....	<b>15</b>
<b>4.1 mSATA MINI 3ME PIN DIRECTIONS</b> .....	<b>15</b>
<b>4.2 ELECTRICAL CONNECTIONS FOR MSATA MINI 3ME</b> .....	<b>15</b>

<b>4.3 DEVICE DRIVE .....</b>	<b>15</b>
<b>5. PART NUMBER RULE .....</b>	<b>16</b>

## REVISION HISTORY

Revision	Description	Date
Preliminary	First Released	May, 2013
1.0	Official release	July, 2013
1.1	Modify mechanical drawing	February, 2014
1.2	Modify pin assignment	April, 2014
1.3	Modify part number code	June, 2014
1.4	Modify part number code	October, 2014
1.5	Modify mechanical drawing	December, 2014
1.6	Remove the Flash endurance SPEC and Add 128GB	February, 2015
1.7	Update mechanical drawing	August, 2015
1.8	Modified mechanical drawing	August, 2016

## List of Tables

<b>TABLE 1: DEVICE PARAMETERS .....</b>	<b>8</b>
<b>TABLE 2: PERFORMANCE .....</b>	<b>8</b>
<b>TABLE 3: INNODISK MSATA MINI 3ME POWER REQUIREMENT .....</b>	<b>8</b>
<b>TABLE 4: POWER CONSUMPTION .....</b>	<b>8</b>
<b>TABLE 5: TEMPERATURE RANGE FOR MSATA MINI 3ME .....</b>	<b>9</b>
<b>TABLE 6: SHOCK/VIBRATION TESTING FOR MSATA MINI 3ME .....</b>	<b>9</b>
<b>TABLE 7: MSATA MINI 3ME MTBF .....</b>	<b>9</b>
<b>TABLE 8: INNODISK MSATA MINI 3ME PIN ASSIGNMENT .....</b>	<b>10</b>

## List of Figures

<b>FIGURE 1: INNODISK MSATA MINI 3ME .....</b>	<b>7</b>
<b>FIGURE 2: INNODISK MSATA MINI 3ME BLOCK DIAGRAM .....</b>	<b>13</b>
<b>FIGURE 3: SIGNAL SEGMENT AND POWER SEGMENT .....</b>	<b>15</b>

# 1. Product Overview

## 1.1 Introduction of Innodisk MSATA MINI 3ME

Innodisk mSATA mini 3ME is designed with mSATA mini form factor by MO-300/MO-300B which established by JEDEC, and support SATA III standard (6.0Gb/s) with excellent performance. Regarding of mechanical interference, Innodisk mSATA mini 3ME absolutely replaces the traditional hard disk and makes personal computer, in any field, smaller and easier.

Innodisk mSATA mini 3ME effectively reduces the booting time of operation system and the power consumption is less than hard disk drive (HDD), and complies with ATA protocol, no additional drives are required, and can be configured as a boot device or data storage device

## 1.2 Product View and Models

Innodisk mSATA mini 3ME is available in follow capacities within MLC flash ICs.

[mSATA mini 3ME 04GB](#)

[mSATA mini 3ME 08GB](#)

[mSATA mini 3ME 16GB](#)

[mSATA mini 3ME 32GB](#)

[mSATA mini 3ME 64GB](#)

[mSATA mini 3ME 128GB](#)



**Figure 1: Innodisk mSATA mini 3ME**

## 1.3 SATA Interface

Innodisk mSATA mini 3ME supports SATA III(6.0Gb/s) interface, and compliant with SATA I (1.5Gb/s) and SATA II(3.0Gb/s).

## 2. Product Specifications

### 2.1 Capacity and Device Parameters

mSATA mini 3ME device parameters are shown in Table 1.

**Table 1: Device parameters**

Capacity	Cylinders	Heads	Sectors	LBA	user space
4GB	7773	16	63	7835184	3,825
8GB	15525	16	63	15649200	7,641
16GB	16383	16	63	31277232	15,272
32GB	16383	16	63	62533296	30,533
64GB	16383	16	63	125045424	61,057
128GB	16383	16	63	242255664	118,289

### 2.2 Performance

Burst Transfer Rate: 6.0Gbps

**Table 2: Performance**

Capacity	04GB	08GB	16GB	32GB	64GB	128GB
Sequential Read (max.)	100 MB/sec	120 MB/sec	240 MB/sec	280 MB/sec	280 MB/sec	280 MB/sec
Sequential Write (max.)	10 MB/sec	20 MB/sec	30 MB/sec	80 MB/sec	80 MB/sec	80 MB/sec

Note: the information is based on CrystalDiskMark 3.01 with file size 1000MB test patent

### 2.3 Electrical Specifications

#### 2.3.1 Power Requirement

**Table 3: Innodisk mSATA mini 3ME Power Requirement**

Item	Symbol	Rating	Unit
Input voltage	V <sub>IN</sub>	+3.3 DC +- 5%	V

#### 2.3.2 Power Consumption

**Table 4: Power Consumption**

Mode	Power Consumption (mA)
Read	197 (max.)
Write	241 (max.)
Idle	155 (max.)

\* Target: 128GB mSATA mini 3ME



## 2.4 Environmental Specifications

### 2.4.1 Temperature Ranges

**Table 5: Temperature range for mSATA mini 3ME**

Temperature	Range
Operating	Standard Grade: 0°C to +70°C
	Industrial Grade: -40°C to +85°C
Storage	-55°C to +95°C

### 2.4.2 Humidity

Relative Humidity: 10-95%, non-condensing

### 2.4.3 Shock and Vibration

**Table 6: Shock/Vibration Testing for mSATA mini 3ME**

Reliability	Test Conditions	Reference Standards
Vibration	7 Hz to 2K Hz, 20G, 3 axes	IEC 68-2-6
Mechanical Shock	Duration: 0.5ms, 1500 G, 3 axes	IEC 68-2-27

### 2.4.4 Mean Time between Failures (MTBF)

Table 7 summarizes the MTBF prediction results for various mSATA mini 3ME configurations. The analysis was performed using a RAM Commander™ failure rate prediction.

- **Failure Rate:** The total number of failures within an item population, divided by the total number of life units expended by that population, during a particular measurement interval under stated condition.
- **Mean Time between Failures (MTBF):** A basic measure of reliability for repairable items: The mean number of life units during which all parts of the item perform within their specified limits, during a particular measurement interval under stated conditions.

**Table 7: mSATA mini 3ME MTBF**

Product	Condition	MTBF (Hours)
Innodisk mSATA mini 3ME	Telcordia SR-332 GB, 25°C	>3,000,000

## 2.5 CE and FCC Compatibility

mSATA mini 3ME conforms to CE and FCC requirements.

## 2.6 RoHS Compliance

mSATA mini 3ME is fully compliant with RoHS directive.

## 2.7 Reliability

Parameter	Value
Read Cycles	Unlimited Read Cycles
Wear-Leveling Algorithm	Support
Bad Blocks Management	Support
Error Correct Code	Support
TBW	
4GB	10.8 (Sequential write)
8GB	21.6 (Sequential write)
16GB	43.2 (Sequential write)
32GB	86.4 (Sequential write)
64GB	172.8 (Sequential write)
128GB	345.6 (Sequential write)

## 2.8 Transfer Mode

mSATA mini 3ME support following transfer mode:

Serial ATA III 6.0Gbps

Serial ATA II 3.0Gbps

Serial ATA I 1.5Gbps

## 2.9 Pin Assignment

Innodisk mSATA mini 3ME uses a standard SATA pin-out. See Table 8 for mSATA mini 3ME pin assignment.

**Table 8: Innodisk mSATA mini 3ME Pin Assignment**

Signal Name	Pin #	Pin #	Signal Name
GND	51	52	+3.3V
DAS	49	50	GND
NC	47	48	NC
NC	45	46	NC
NC	43	44	NC

+3.3V	41	42	NC
+3.3V	39	40	GND
GND	37	38	NC
GND	35	36	NC
RX+	33	34	GND
RX-	31	32	NC
GND	29	30	NC
GND	27	28	NC
TX-	25	26	GND
TX+	23	24	+3.3V
GND	21	22	NC
NC	19	20	NC
NC	17	18	GND
GND	15	16	NC
NC	13	14	NC
NC	11	12	NC
GND	9	10	NC
NC	7	8	NC
NC	5	6	NC
NC	3	4	GND
NC	1	2	+3.3V

## 2.10 Mechanical Dimensions

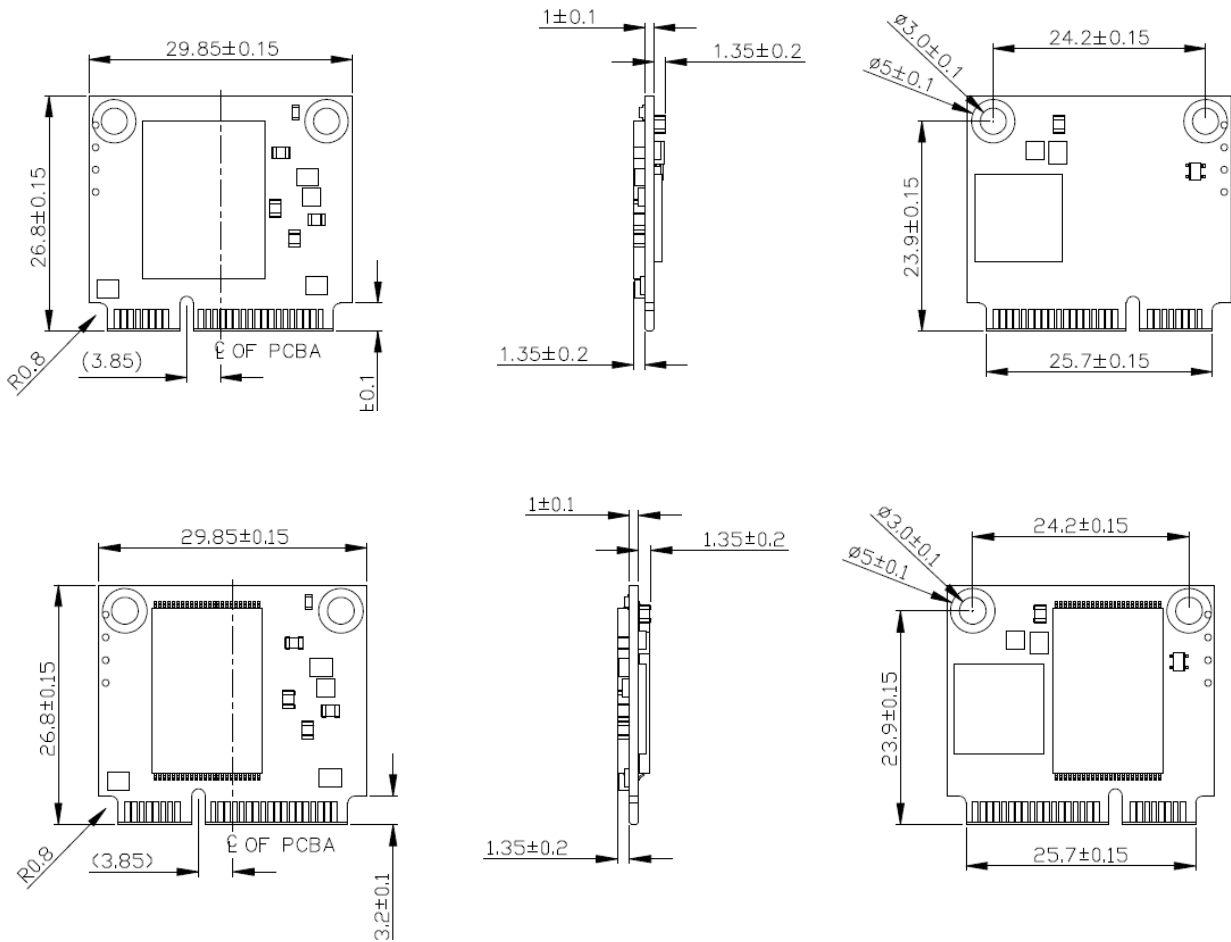

## 2.11 Assembly Weight

An Innodisk mSATA mini 3ME within flash ICs, 32GB's weight is 8 grams approximately.

## 2.12 Seek Time

Innodisk mSATA mini 3ME is not a magnetic rotating design. There is no seek or rotational latency required.

## 2.13 NAND Flash Memory

Innodisk mSATA mini 3ME uses Multi Level Cell (MLC) NAND flash memory, which is non-volatility, high reliability and high speed memory storage. Each cell stores 2 bits or holds four states per cell. Read or Write data to flash memory for SSD is control by microprocessor.

### 3. Theory of Operation

#### 3.1 Overview

Figure 2 shows the operation of Innodisk mSATA mini 3ME from the system level, including the major hardware blocks.

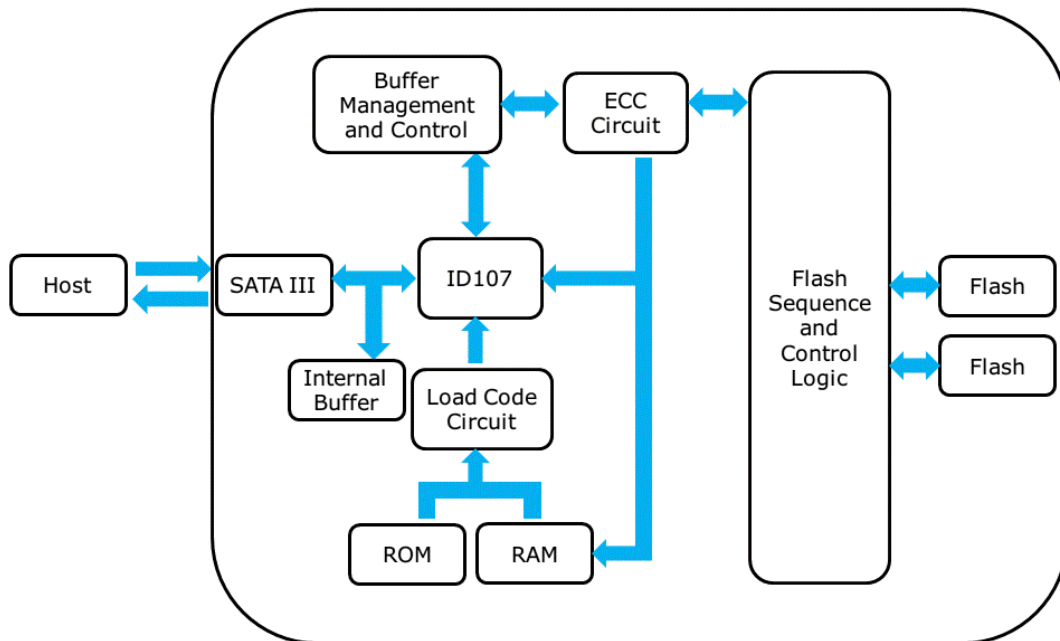

**Figure 2: Innodisk mSATA mini 3ME Block Diagram**

Innodisk mSATA mini 3ME integrates a SATA III controller and NAND flash memories. Communication with the host occurs through the host interface, using the standard ATA protocol. Communication with the flash device(s) occurs through the flash interface.

#### 3.2 SATA III Controller

Innodisk mSATA mini 3ME is designed with ID 107, a SATA III 6.0Gbps (Gen. 3) controller. The Serial ATA physical, link and transport layers are compliant with Serial ATA Gen 1, Gen 2 and Gen 3 specification (Gen 3 supports 1.5Gbps/3.0Gbps/6.0Gbps data rate). The controller has 2 channels for flash interface.

### 3.3 Error Detection and Correction

Highly sophisticated Error Correction Code algorithms are implemented. The ECC unit consists of the Parity Unit (parity-byte generation) and the Syndrome Unit (syndrome-byte computation). This unit implements an algorithm that can correct 40 bits per 1024 bytes in an ECC block. Code-byte generation during write operations, as well as error detection during read operation, is implemented on the fly without any speed penalties.

### 3.4 Wear-Leveling

Flash memory can be erased within a limited number of times. This number is called the **erase cycle limit** or **write endurance limit** and is defined by the flash array vendor. The erase cycle limit applies to each individual erase block in the flash device.

Innodisk mSATA mini 3ME uses a static wear-leveling algorithm to ensure that consecutive writes of a specific sector are not written physically to the same page/block in the flash. This spreads flash media usage evenly across all pages, thereby extending flash lifetime.

### 3.5 Bad Blocks Management

Bad Blocks are blocks that contain one or more invalid bits whose reliability are not guaranteed. The Bad Blocks may be presented while the SSD is shipped, or may develop during the life time of the SSD. When the Bad Blocks is detected, it will be flagged, and not be used anymore. The SSD implement Bad Blocks management, Bad Blocks replacement, Error Correct Code to avoid data error occurred. The functions will be enabled automatically to transfer data from Bad Blocks to spare blocks, and correct error bit.

### 3.6 Power Cycling

Innodisk's power cycling management is a comprehensive data protection mechanism that functions before and after a sudden power outage to SSD. Low-power detection terminates data writing before an abnormal power-off, while table-remapping after power-on deletes corrupt data and maintains data integrity. Innodisk's power cycling provides effective power cycling management, preventing data stored in flash from degrading with use.

### 3.7 Garbage Collection

Garbage collection is used to maintain data consistency and perform continual data cleansing on SSDs. It runs as a background process, freeing up valuable controller resources while sorting good

data into available blocks, and deleting bad blocks. It also significantly reduces write operations to the drive, thereby increasing the SSD's speed and lifespan.

## 4. Installation Requirements

### 4.1 mSATA mini 3ME Pin Directions

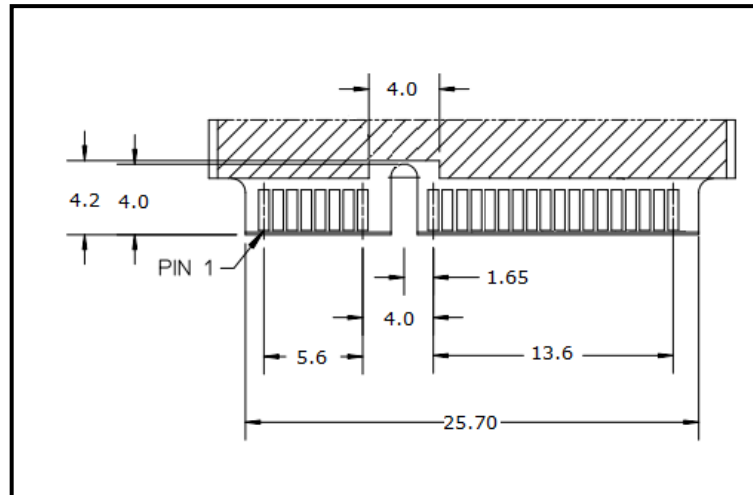

**Figure 3: Signal Segment and Power Segment**

### 4.2 Electrical Connections for mSATA mini 3ME

A Serial ATA device may be either directly connected to a host or connected to a host through an adaptor card. The SATA interface has a separate connector for the power supply. Please refer to the pin description for further details.

### 4.3 Device Drive

No additional device drives are required. The Innodisk mSATA mini 3ME can be configured as a boot device.

## 5. Part Number Rule

CODE	1	2	3	4	5	6	7	8	9	10	11	12	13	14	15	16	17	18	19	20	21
	D	E	M	S	M	-	6	4	G	D	0	7	R	C	1	D	C	-	X	X	X
<b>Definition</b>																					
<b>Code 1<sup>st</sup> (Disk)</b>											<b>Code 13<sup>th</sup> (Flash mode)</b>										
D : Disk											R: Toshiba A19 Synchronous Flash for 3ME/3MG-P/3MR series										
<b>Code 2<sup>nd</sup> (Feature set)</b>											S: Synchronous flash										
E : Embedded series											<b>Code 14<sup>th</sup> (Operation Temperature)</b>										
<b>Code 3<sup>rd</sup> ~5<sup>th</sup> (Form factor)</b>											C: Standard Grade (0°C ~ +70°C)										
MSM: mSATA mini											W: Industrial Grade (-40°C ~ +85°C)										
<b>Code 7<sup>th</sup> ~9<sup>th</sup> (Capacity)</b>											<b>Code 15<sup>th</sup> (Internal control)</b>										
04G:4GB											1~9: TSOP PCB version. A~Z: BGA PCB version.										
08G:8GB																					
16G:16GB											<b>Code 16<sup>th</sup> (Channel of data transfer)</b>										
32G:32GB											S: Single Channel										
64G:64GB											D: Dual Channels										
A28:128GB											<b>Code 17<sup>th</sup> (Flash Type)</b>										
<b>Code 10<sup>th</sup> ~12<sup>th</sup> (Controller)</b>											C: Toshiba MLC										
D07: ID107											<b>Code 19<sup>th</sup>~21<sup>st</sup> (Customize code)</b>										



# Appendix

## CE/FCC/RoHS/REACH

### Verification of Compliance

Product Name : mSATA mini 3ME / 3SE / 3IE  
 Model Number : D@MSM-XXXD07\* # % ※ &  
 @: Feature set (G: EverGreen, H: iSLC, R:InnoRobust,  
 E: Embedded)  
 XXX: 4GB~64GB  
 \* : Flash Mode  
 #: Temperature (C : Commercial Temp W : Industrial Temp)  
 % : PCB Version (A, B, C... or 1, 2, 3...)  
 ※ : Channel (S : Single, D:Dual, T: Three, Q : Quad, E : Eight)  
 & : Flash Vender ( T : Micron SLC, S : Samsung SLC,  
 N : Micron MLC, B : Toshiba SLC, C: Toshiba MLC,  
 F: Sandisk SLC, X: SLC )

Applicant : InnoDisk Corporation  
 Address : 9F, No.100, Sec. 1, Xintai 5th Rd., Xizhi Dist., New Taipei City 221,  
 Taiwan

Report Number : O22-U070-1306-274  
 Issue Date : July 22, 2013  
 Applicable Standards : EN 55022:2010 Class B ITE  
 AS/NZS CISPR22:2009 Class B ITE  
 EN 55024:2010  
 EN 61000-4-2:2009  
 EN 61000-4-3:2006+A1:2008+A2:2010  
 EN 61000-4-4:2004+A1:2010

Based on the EMC Directive 2004/108/EC and the specifications of the customer, one sample of the designated product has been tested in our laboratory and found to be in compliance with the EMC standards cited above.



TAF 0905  
 FCC CAB Code TW1053  
 NVLAP Lab Code 200575-0  
 IC Code 4699A  
 VCCI Accep. No. R-1527, C-1609, T-1441, G-10,  
 C-4400, T-1334, G-614



**Central Research Technology Co.**  
 EMC Test Laboratory  
 11, Lane 41, Fushuen St., Jungshan Chiu,  
 Taipei, Taiwan, 104, R.O.C.  
 Tel : 886-2-25984568  
 Fax: 886-2-25984546

*J. Y. Shih*

(Tsun-Yu Shih/ General Manager)

Date: July 22, 2013



## Verification of Compliance

Product Name : mSATA mini 3ME / 3SE / 3IE  
 Model Number : D@MSM-XXXD07\* # % ※ &  
 @: Feature set (G: EverGreen, H: iSLC, R:InnoRobust,  
 E: Embedded)  
 XXX: 4GB~64GB  
 \* : Flash Mode  
 #: Temperature (C : Commercial Temp W : Industrial Temp)  
 % : PCB Version (A, B, C... or 1, 2, 3...)  
 ※ : Channel (S : Single, D: Dual, T: Three, Q : Quad, E : Eight)  
 & : Flash Vender ( T : Micron SLC, S : Samsung SLC,  
 N : Micron MLC, B : Toshiba SLC, C: Toshiba MLC,  
 F: Sandisk SLC, X: SLC )

Applicant : InnoDisk Corporation  
 Address : 9F, No.100, Sec. 1, Xintai 5th Rd., Xizhi Dist., New Taipei City 221,  
 Taiwan

Report Number : F-U070-1306-274  
 Issue Date : July 22, 2013

Applicable Standards : FCC Part 15, Subpart B Class B ITE  
 ANSI C63.4:2009  
 Industry Canada ICES-003 Issue 5  
 CSA-IEC CISPR22-10 Class B ITE

One sample of the designated product has been tested in our laboratory and found to be in compliance with the FCC rules cited above.



NVLAP LAB CODE 200575-0

TAF 0905

FCC CAB Code TW1053

IC Code 4699A

VCCI Accep. No. R-1527, C-1609, T-1441, G-10,

C-4400, T-1334, G-614



### Central Research Technology Co.

EMC Test Laboratory  
 11, Lane 41, Fushuen St., Jungshan Chiu,  
 Taipei, Taiwan, 104, R.O.C.  
 Tel : 886-2-25984568  
 Fax: 886-2-25984546

(Tsun-Yu Shih/ General Manager)

Date: July 22, 2013



宜鼎國際股份有限公司  
Innodisk Corporation

Tel:(02)7703-3000 Fax:(02) 7703-3555 Internet: <http://www.innodisk.com/>

RoHS 自我宣告書 (RoHS Declaration of Conformity)

Manufacturer Product: All Innodisk EM Flash and Dram products

- 一、宜鼎國際股份有限公司（以下稱本公司）特此保證售予貴公司之所有產品，皆符合歐盟 2011/65/EU 關於 RoHS 之規範要求。

Innodisk Corporation declares that all products sold to the company, are complied with European Union RoHS Directive (2011/65/EU) requirement

- 二、本公司同意因本保證書或與本保證書相關事宜有所爭議時，雙方宜友好協商，達成協議。

Innodisk Corporation agrees that both parties shall settle any dispute arising from or in connection with this Declaration of Conformity by friendly negotiations.

Name of hazardous substance	Limited of RoHS ppm (mg/kg)
Cd	< 100 ppm
Pb	< 1000 ppm
Hg	< 1000 ppm
Chromium VI (Cr+6)	< 1000 ppm
Polybromodiphenyl ether (PBDE)	< 1000 ppm
Polybrominated Biphenyls (PBB)	< 1000 ppm

立 保 證 書 人 (Guarantor)

Company name 公司名稱：Innodisk Corporation 宜鼎國際股份有限公司

Company Representative 公司代表人：Richard Lee 蔡鍾亮

Company Representative Title 公司代表人職稱：CEO 執行長

Date 日期：2014 / 07 / 29





宜鼎國際股份有限公司  
Innodisk Corporation

Tel:(02)7703-3000 Fax:(02) 7703-3555 Internet: <http://www.innodisk.com/>

## REACH Declaration of Conformity

### Manufacturer Product: All Innodisk EM Flash and Dram products

1.宜鼎國際股份有限公司（以下稱本公司）特此保證此售予貴公司之產品，皆符合歐盟化學品法案(Registration, Evaluation and Authorization of Chemicals: REACH)之規定

(<http://www.echa.europa.eu/de/candidate-list-table> last updated: 16/05/2014)。所提供之產品包含：(1) 產品或產品所使用到的所有原物料；(2) 包裝材料；(3) 設計、生產及重工過程中所使用到的所有原物料。

We Innodisk Corporation hereby declare that our products are in compliance with the requirements according to the REACH Regulation

(<http://www.echa.europa.eu/de/candidate-list-table> last updated: 16/06/2014).

Products include: 1) Product and raw material used by the product; 2) Packaging material; 3) Raw material used in the process of design, production and rework

2.本公司同意因本保證書或與本保證書相關事宜有所爭議時，雙方宜友好協商，達成協議。

InnoDisk Corporation agrees that both parties shall settle any dispute arising from or in connection with this Declaration of Conformity by friendly negotiations.

### 立保證書人 (Guarantor)

Company name 公司名稱：InnoDisk Corporation 宜鼎國際股份有限公司

Company Representative 公司代表人：Richard Lee 李鐘亮

Company Representative Title 公司代表人職稱：CEO 執行長

Date 日期：2014 / 07 / 29

