

Datasheet

# ServerDOM-L

## 31E series

- Bootable and compatible with all OS
- Better reliability and MTBF than HDD
- Small dimension for Blade or 1U servers
- Compatible with Intel® RSTe
- Cost effective storage solution
- SATA Pin 8 VCC to enhance reliability and save space
- Customizable for IPMI
- Unexpected power loss protection



## Introduction

Innodisk ServerDOM is dedicated to the further of server design. By using ServerDOM as a boot drive, there is more space for the hot-swappable data storage devices.

Innodisk ServerDOM supports SATA III standard (6.0Gb/s) interface with excellent performance and the innovative Pin8 uses the SATA connector itself as a power supply to drive the device without external cables. It could be connected directly to the SATA on-board socket on customers' system without additional power cable. Besides, the booting time for operation and the power consumption is less than hard disk drive (HDD), and can work under harsh environment compile with ATA protocol, no additional drives are required, and the SSD can be configured as a boot device or data storage device.

# ServerDOM-L

## 3IE series

### Drawing

Contact us for more information about the ServerDOM-L 3IE

Innodisk is a service-driven provider of industrial embedded flash and DRAM storage products and technologies, with a focus on the industrial/embedded, aerospace and defense, and cloud computing industries.

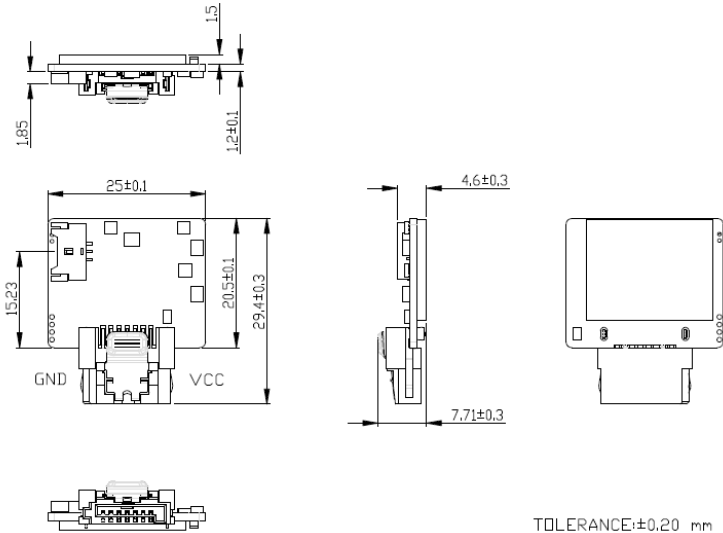

#### Headquarters (Taiwan)

5F. No.237, Sec. 1, Datong Rd.,  
Xizhi Dist., New Taipei City,  
Taiwan (R.O.C.)  
Tel: +886-2-77033000  
Email: sales@innodisk.com

#### Branch Offices:

USA  
[usasales@innodisk.com](mailto:usasales@innodisk.com)  
+1-510-770-9421  
Europe  
[eusales@innodisk.com](mailto:eusales@innodisk.com)  
+31-40-282-1818  
Japan  
[jpsales@innodisk.com](mailto:jpsales@innodisk.com)  
+81-3-6667-0161  
China  
[sales\\_cn@innodisk.com](mailto:sales_cn@innodisk.com)  
+86-755-21673689

[www.innodisk.com](http://www.innodisk.com)

© 2015 Innodisk Corporation.  
All right reserved. Specifications  
are subject to change without  
prior notice.

20151208

## Specifications

Interface	SATA III 6Gb/s
Flash Type	MLC
Capacity (GB)	8, 16, 32
Max. Channels	4
Sequential R/W (MB/sec, Max.)	480 / 270
Voltage	+5V ±10%
Max. Power Consumption	2.5 W
ATA Security	Supported
S.M.A.R.T.	Supported
Dimension	25 X 29.4 X 7.2 mm
Environmental Specifications	Standard operation: 0°C ~ +70°C
Environment	Vibration: 20G @7~2000Hz Shock: 1500G @ 0.5ms Storage Temperature: -55°C ~ +95°C MTBF: 3 million hours
OS Support	Windows series, Linux

## Ordering Information

Operation Temp.	8GB	16GB	32GB
Standard Grade (0°C ~ +70°C)	DHSNL-08GD063CCDYA	DHSNL-16GD063CCQYA	DHSNL-32GD063CCQYA
Standard Grade (Pin7+Pin8)	DHSNL-08GD063CCDYB	DHSNL-16GD063CCQYB	DHSNL-32GD063CCQYB

\*PN end with A: Pin8+ power cable  
B: Pin8+ Pin 7



[www.innodisk.com](http://www.innodisk.com)