

QBi-4200B (MZAPLBH)

Embedded Compact Board with Intel® N4200 Processor, DDR3L memory, 1 x COM, 1 x SATA 6Gb/s, 7 x USB

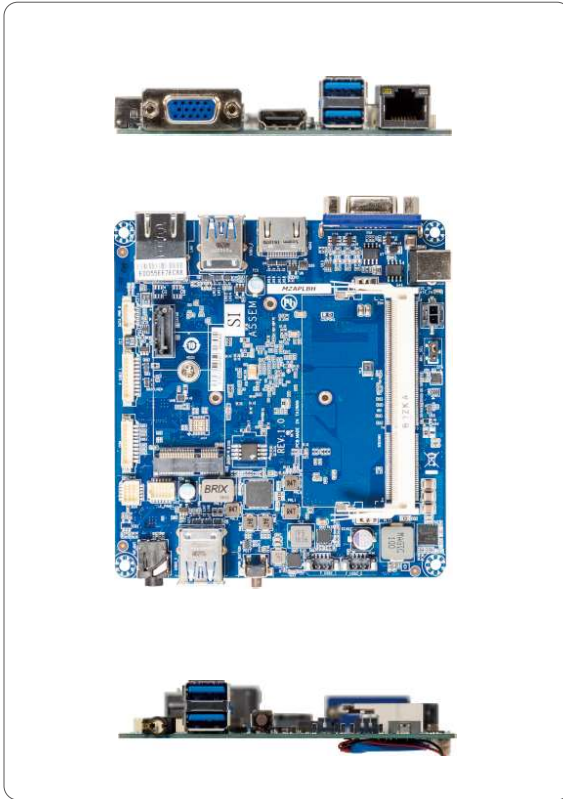

Features

- Embedded IPC Motherboard
- Intel® Pentium® Processor N4200
- Single Channel DDR3L, 1 x SO-DIMM
- 1 x GbE LAN port
- 1 x SATA 6Gb/s port
- HDMI, D-sub port, eDP ports for multiple display
- 1 x RS232 COM port

Raid	—
Expansion Slots	1 x 2230 M.2 E-Key
Internal I/O	1 x 2 pin power connector 1 x SATA Power header 1 x CPU fan header 1 x Front panel header 2 x USB 2.0 headers 1 x USB 3.0 header 1 x COM header (RS232)
Front IO	2 x USB 3.0 1 x Power button 1 x Audio Combo Jack (Headphone & Microphone)
Rear IO	1 x HDMI 1 x VGA 1 x RJ45 LAN port 2 x USB 3.0
Side IO	1 x DC Jack (+12V~24VDC)
TPM	—
OS Compatibility	Windows 10 (x64)
Operating Properties	Operating temperature: 0°C to +60°C Operating humidity: 0-90% (non-condensing) Non-operating temperature: -40°C to +85°C Non-operating humidity: 0%-95% (non-condensing)

Specifications

Form Factor	Embedded Compact Board 105W x 110D (mm)
CPU	Intel® Pentium® Processor N4200 14nm, 4 cores, 4 threads, up to 2.50 GHz TDP 6W 2 MB L2 cache
Socket	1 x FCBGA1296
Chipset	—
Memory	1 x DDR3L SO-DIMM sockets, Max. Capacity 8GB Support Single Channel DDR3L 1866MHz memory module
Ethernet	1 x GbE LAN port (Realtek® RTL8111HS)
Video	Integrated Graphics Processor - Intel® HD Graphics 505: 1 x HDMI 1.4 port, supporting a maximum resolution of 3840x2160 @30Hz 1 x VGA port: supporting a maximum resolution 2560x1600 @60Hz 1 x eDP port, supporting a maximum resolution of 1920x1080 @60Hz (3 independent display outputs)
Audio	Realtek® Audio codec
Storage	1 x SATA 6Gb/s port

GIGAIPC reserves the right to modify or change technical data without prior notice.

Dimension

Unit: mm

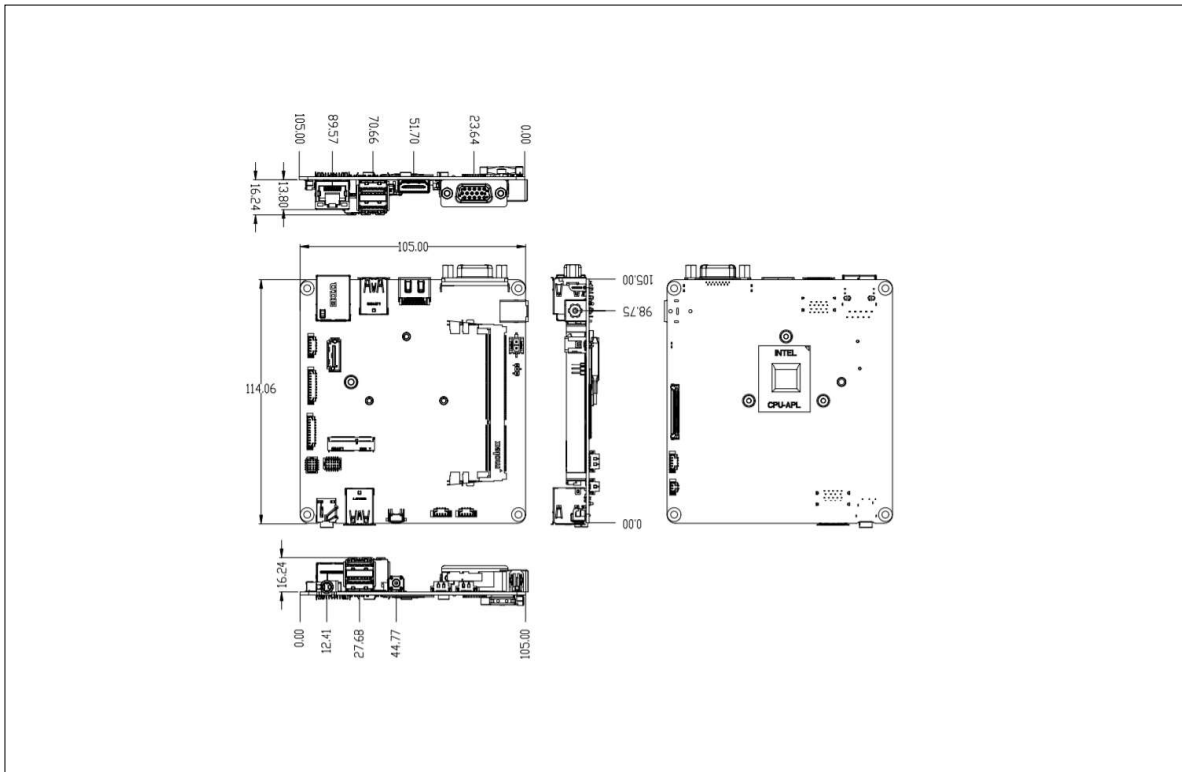

Packing Content

- Box Packing Capacity: 10pcs
- Carton size: 465 x 351 x 217(mm)
- Content:
 - SATA Power cable 150mm x 1 (P/N: 25CRI-150621-K1R)

Order Information

- Motherboard : 9MZAPLBHMR-SI

Optional Kit

- Fanless Heatsink P/N: 12SP2-090018-00R
- Heat spreader P/N: 25ST5-CGAA00-A8R
- TPM 2.0 module P/N: 9CTM000NR-00
- TPM Cable P/N: 25CRZ-100600-S9R

GIGAIPC reserves the right to modify or change technical data without prior notice.