

OCUEKIT1

OCUE4221L + OCUD4241 OCuLink Expansion Kit (with low-profile bracket)

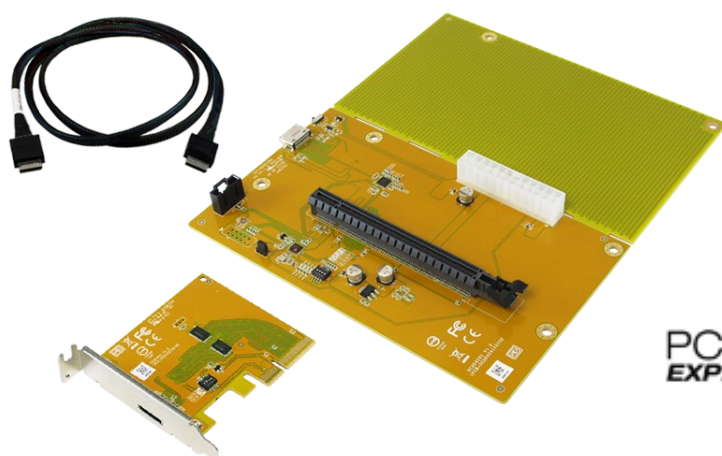

Introduction

The **OCUE4221L** is a standard **PCIe x4 HH card with low profile bracket** and the **OCUE4221** is a standard PCIe x4 HH card with full height bracket that support PCIe Gen4 x4 and connect to an SFF-8612 OCuLink port, enabling external PCIe expansion. Paired with the **OCUD4241**, a PCIe device board, this kit allows users to extend the PCIe bus outside of the system—supporting external graphics card or SAS/SATA storage RAID card—without the need to upgrade their existing PC or workstation.

Key Applications & Benefits

- **External GPU Support (eGPU)**
 - ✓ Connect high-performance graphics cards for demanding 3D applications, video editing, or immersive gaming.
 - ✓ Ideal for Mini PC, small form factor PCs, or systems that don't support internal GPU upgrades.
- **External SAS/SATA Storage Expansion**
 - ✓ Easily connect SAS or SATA RAID/HBA cards to add multiple hard drives or SSDs via external enclosures.
 - ✓ Perfect for video editing, large-scale backups, media archiving, or data center applications.
- **Cost-Effective Performance Boost**
 - ✓ Avoid the cost of a full system upgrade—simply add GPU or storage expansion externally.
 - ✓ Flexible and modular approach to upgrading: expand only what you need, when you need it.

Specifications

■ OCUE4221L / OCUE4221

Bus	PCIe Gen4x4
Interface	SFF 8612 4i 42pin
Controller	PHISON PS7101
Redriver settings	By BIOS or MCU(OCUD4241)
Form Factor	PCIe low profile PCB
ESD Protection	±8KV Air / ±4KV Contact
Green Product	RoHS, WEEE
Regulatory Approvals	CE / FCC / VCCI / BSMI
Operation Temperature	0 to 50°C (32 to 122°F)
Operation Humidity	< 85% non-condensing
Storage Temperature	-20 to 85°C (-4 to 185°F)
PCB Dimensions	79.3 x 68.5 mm
Bracket	OCUE4221L Low Profile 80 mm / OCUE4221 Standard 121 mm

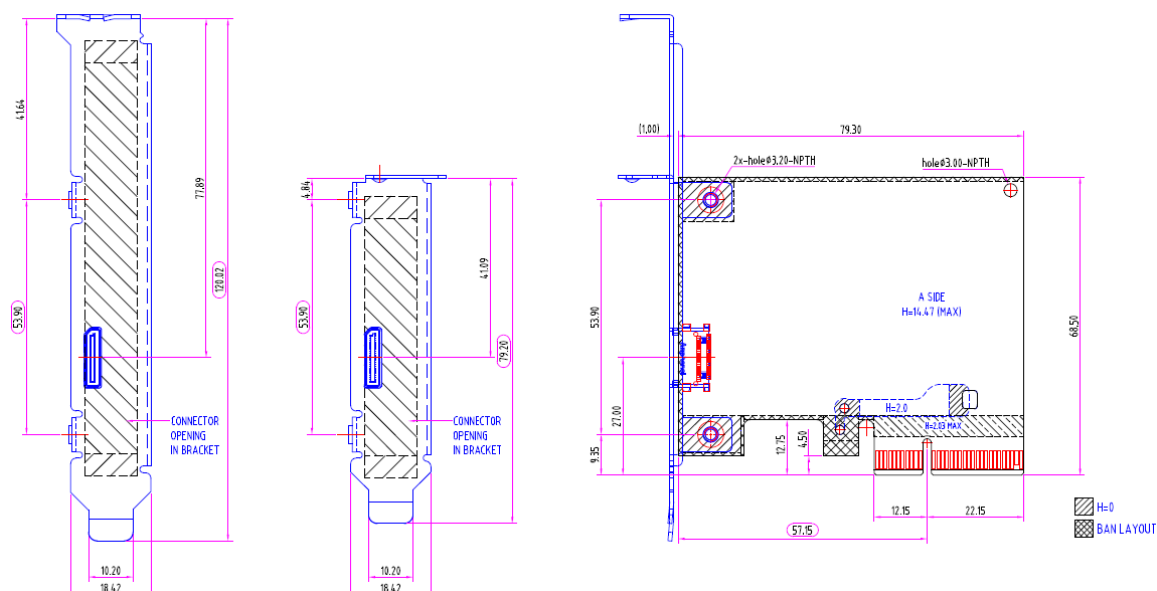

■ **OCUD4241**

Bus	PCIe Gen4x4
Interface	SFF 8612 4i 42pin
PCIe Slot	PCIe x16 (4 lanes)
MCU settings	By I2C set PCIe driving strength
Form Factor	Mini-ITX PC case supported
ESD Protection	±8KV Air / ±4KV Contact
Green Product	RoHS, WEEE
Regulatory Approvals	CE / FCC / VCCI / BSMI
Operation Temperature	0 to 50°C (32 to 122°F)
Operation Humidity	< 85% non-condensing
Storage Temperature	-20 to 85°C (-4 to 185°F)
PCB Dimensions	203.2 x 107.2 mm
I/O Shield	Support standard ATX case

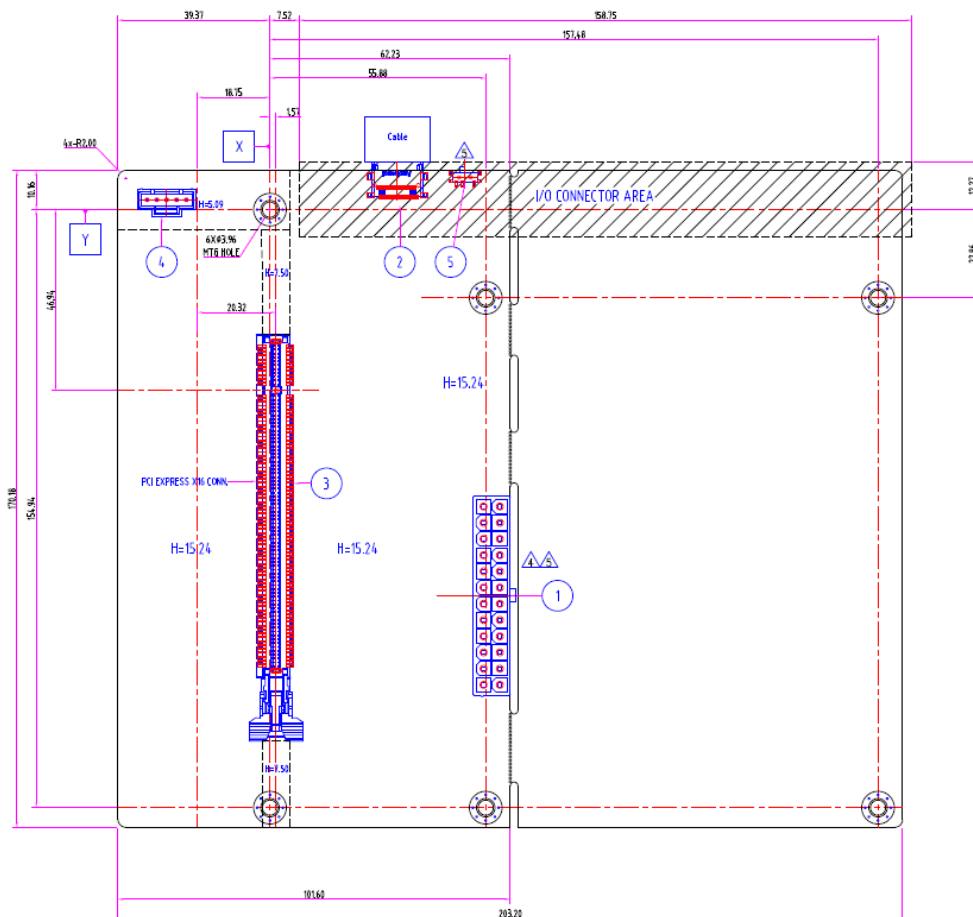

■ Cable



(100cm external cable)

■ I/O Shield (optional)

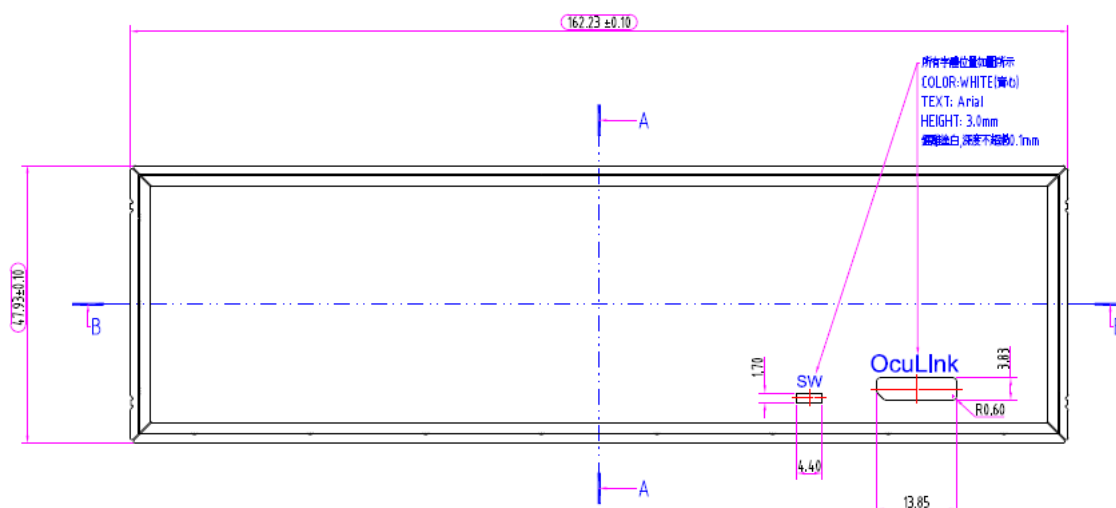

Ideal For

- Creative professionals needing both high GPU performance and large-capacity storage.
- IT & enterprise users looking to extend SAS/SATA RAID or JBOD systems externally.
- Gamers and power users wanting better performance on compact or older systems.
- Mini PC or laptop users requiring PCIe expansion without internal space for upgrades

Package

- OCUE4221L, OCuLink PCIe Gen4x4 to SFF-8612 (1pcs)
- OCUD4241, OCuLink Device board SFF-8612 Gen4x4 to PCIe x16 (1pcs)
- SFF 8611 male to male 100cm external cable (1pcs)
- Quick Installation Guide
- I/O Shield (Optional)