



NEW PRODUCT SPEC SHEET

Model Number: G666R1

- For Intel® Xeon® Processor X5500 Series and X5600 Series, Socket LGA1366
- Active cooler for 2U Servers & Up
- RoHS Compliant

Overall Specification:

- Dimension: 90.0mm x 90.0mm x 65.0mm
- Weight: 500g
- Material: Aluminum Fins with Heat Pipes directly contact CPU
- With 60x60x25mm Side-blow cooling fan
- Cooler Mounted in Captive design
- Shin-Etsu G751 Thermal Grease Pre-printed
- Support CPU power up to 130Watts Heat Dissipation

Fan Specification:

- Model# : DF126025BU - PWMG
- Rated Speed:
 - At Duty Cycle 20%: 1700± 10%RPM
 - At Duty Cycle 50%: 4000± 10%RPM
 - At Duty Cycle 100%: 8000 Min.
- Bearing: 2X Ball
- Rated Voltage: 12V
- Power Consumption :
 - At Duty Cycle 20%: 0.6W
 - At Duty Cycle 50%: 1.8W
 - At Duty Cycle 100%: 7.2W

- Rated Airflow:
 - At Duty Cycle 20%: 8.855 cfm
 - At Duty Cycle 50%: 21.97 cfm
 - At Duty Cycle 100%: 46.44 cfm
- Acoustical Noise:
 - At Duty Cycle 20%: 21.8 dBA
 - At Duty Cycle 50%: 34.5 dBA
 - At Duty Cycle 100%: 52.8dBA
- Air Pressure
 - At Duty Cycle 20%: 0.86 mm-H2O
 - At Duty Cycle 50%: 4.76 mm-H2O
 - At Duty Cycle 100%: 21.50 mm-H2O
- Lead Wire Pin Out:
 - Pin#1-Black(-)
 - Pin#2- Yellow(+)
 - Pin#3- Green(Tachometer/ Signal Output)
 - Pin#4- Blue (PWM)

Thermal Spec & Chart :

Testing Equipment: Intel® Socket1366 TTV

Thermal Design Power :130Watts

T_{LA}: 40 degreeC

Testing Interval: 90mins

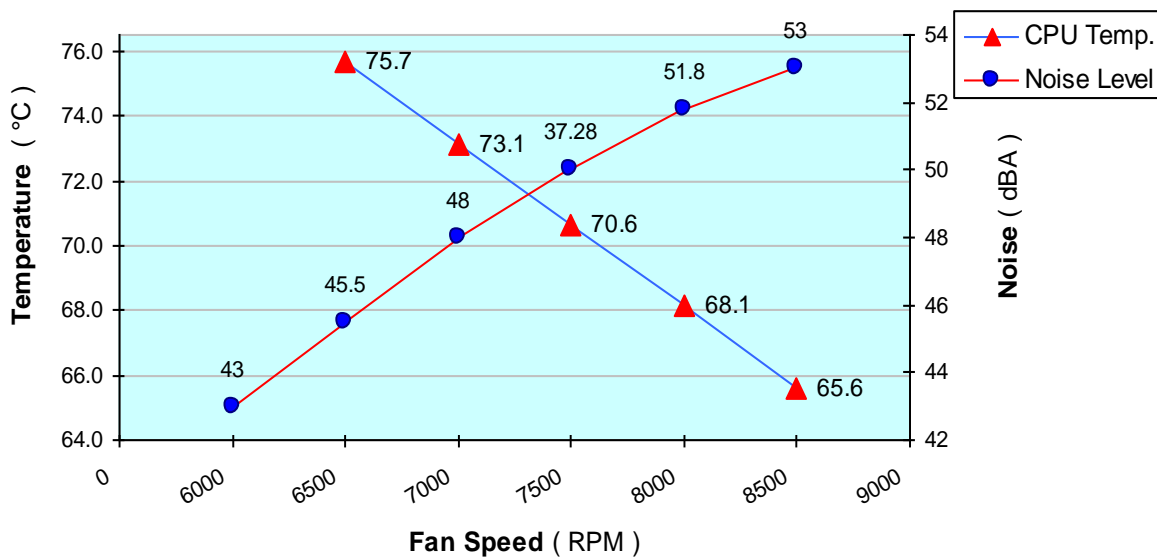

CONFIDENTIAL DOCUMENT

THIS DRAWING CONTAINS INFORMATION PROPRIETARY TO DYNATRON CORPORATION AND DYNAEON INDUSTRIAL CO., LTD. ANY REPRODUCTION, DISCLOSURE, OR USE OF THIS DRAWING IS EXPRESSLY PROHIBITED EXCEPT AS DYNATRON CORPORATION AND DYNAEON INDUSTRIAL CO., LTD. MAY OTHERWISE AGREE TO IN WRITING.

ITEM#	DESCRIPTION	CHECKER	DATE
1	INITIAL RELEASE	LANG	11/16/12

ASSEMBLY PARTS

WHOLE SET OF COOLER

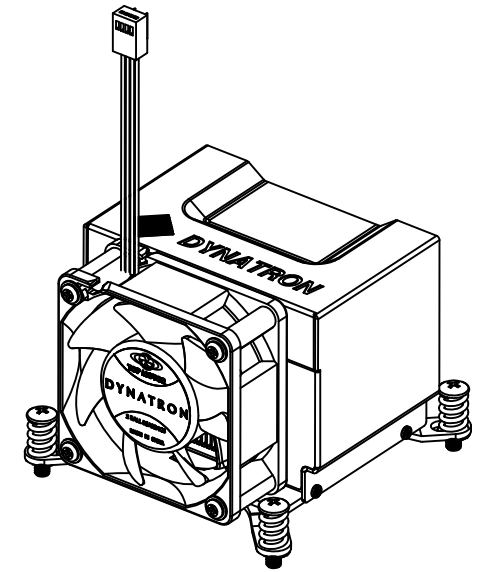
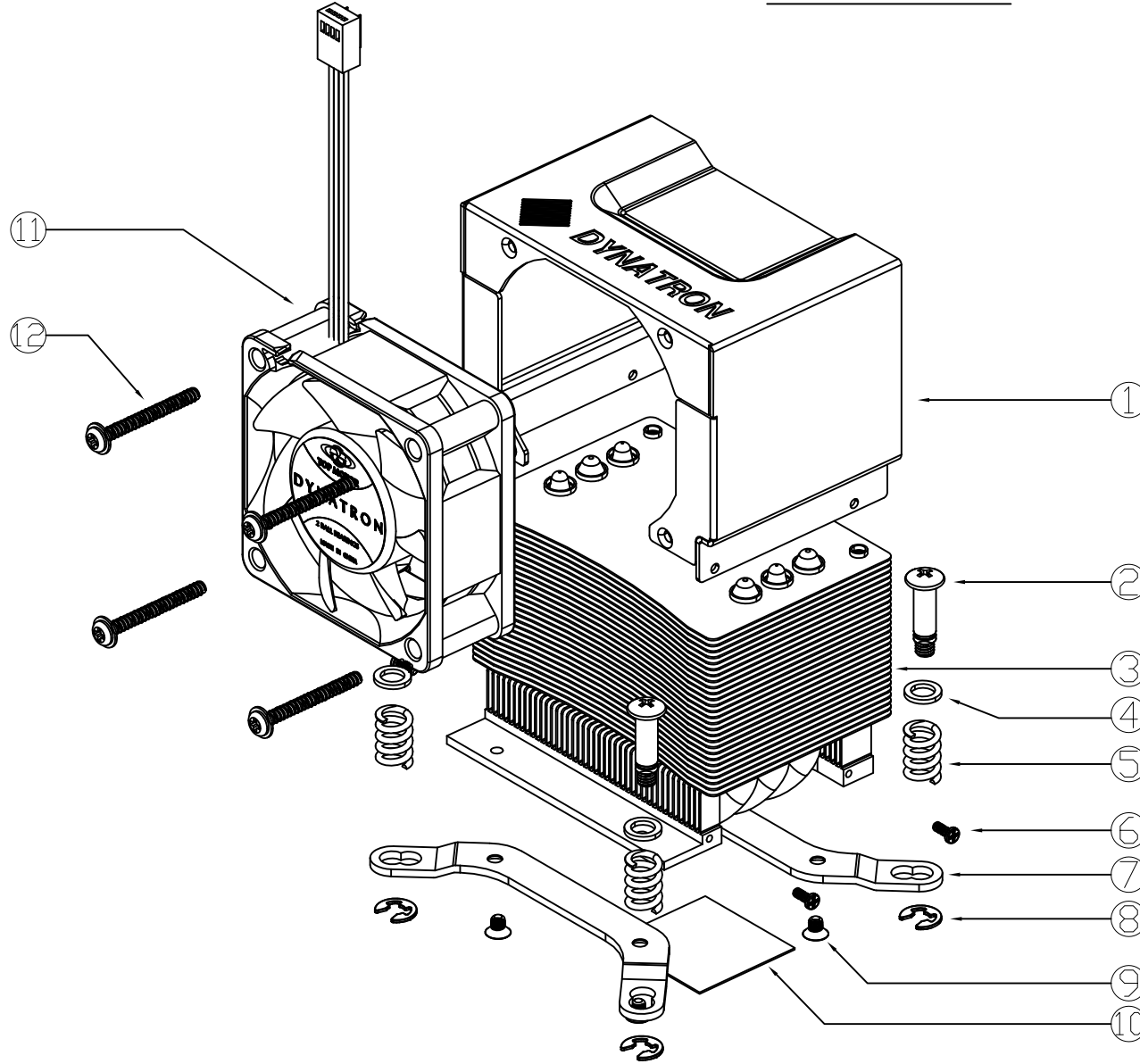

12	SCREW, FAN	STEEL	4
11	FAN, DF126025BU-PWVG, 8000RPM	PLASTIC	1
10	THERMAL GREASE, PRINTED	SHIN-ETSU G751	1
9	SCREW, RETENTION	STEEL	4
8	C-RING	STEEL	4
7	RETENTION	SK7	2
6	SCREW, FAN COVER	STEEL	4
5	SPRING, 10mmL	SUS304	4
4	WASHER	STEEL	4
3	HEATSINK	CU.BASE+AL.FIN+HP	1
2	SCREW, HEATSINK, M3x0.5	STEEL	4
1	COVER, FAN	ALUMINUM	1
ITEM#	DESCRIPTION	MATERIAL	QTY.

NOTES:

1. THE FIGURE IS FOR REFERENCE ONLY, AND NOT FOR SCALE
2. OVERALL DIMENSION: 90.7 x 85.0 x 64.5 mm
3. OVERALL WEIGHT: 500g

DATE	NAME		
DRAWN 11/16/12	enr	TITLE: 2U Active Cooler G666 (MFG# : LC06250044) BOM & Exploded Assembly Drawing	
CHECKED 11/16/12	LANG		
ENG. APPR.			
MFG. APPR.			
QA			
COMMENTS:		DWG. No:	REV
		DYN-EP-G666 R1	00

ITEM#	DESCRIPTION	CHECKER	DATE
01	INITIAL RELEASE	LANG	11/16/2012

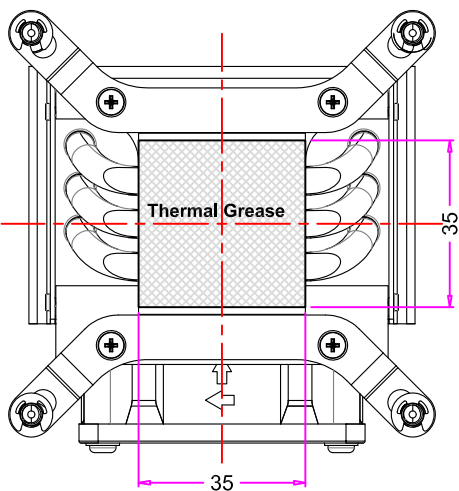
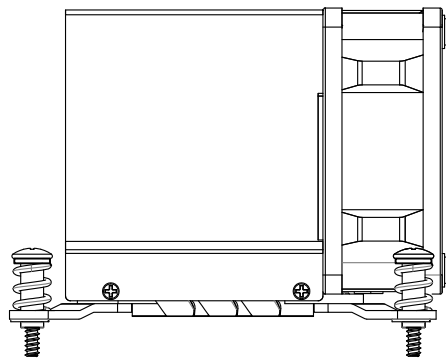
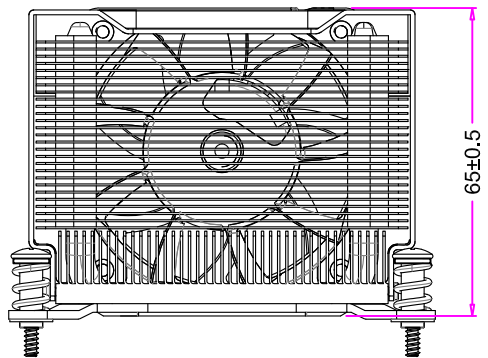
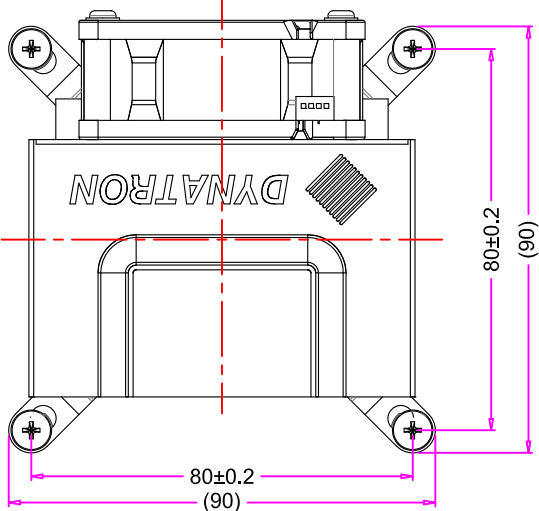
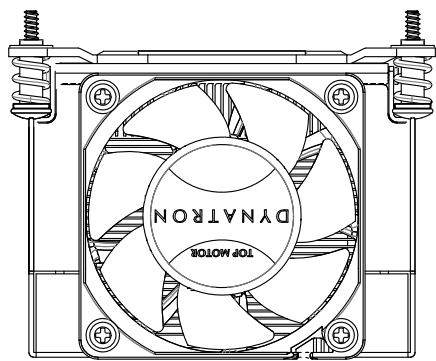

	NAME	DATE
DRAWN BY	ENGR	11/16/2012
CHECKED BY	LANG	11/16/2012
ENG. APPROVED		
MFG. APPROVED	-	-
Q.A.	-	-



DYNATRON CORPORATION

TITLE: 2U Active Cooler **G666**
(MFG# : LC06250044)
Overall Dimension Drawing

CONFIDENTIAL DOCUMENT
THIS DRAWING CONTAINS INFORMATION PROPRIETARY TO DYNATRON CORPORATION AND DYNAEON INDUSTRIAL CO., LTD. ANY REPRODUCTION, DISCLOSURE, OR USE OF THIS DRAWING IS EXPRESSLY PROHIBITED EXCEPT AS DYNATRON CORPORATION AND DYNAEON INDUSTRIAL CO., LTD. MAY OTHERWISE AGREE TO IN WRITING.

VIEW	
UNITS	MM

DWG. No:	DYN-DM-G666 R1	REV.	00
----------	-----------------------	------	-----------